



LET'S FLY!

Bike Machinery Trading Co.Ltd  
4F-1., No 499, Jhongming S. Rd.  
West district, Taichung, Taiwan  
itm@biketradng.com.tw

ITM Bike Componets Srl  
Piazza Camozzi, 9  
24064 Grumello del Monte (BG) - Italy  
sales@itm.it

www.itm.it

## ITM WHEEL USER MANUAL

Thank you for choosing ITM Wheels, a product that will guarantee performance and safety over time.

ITM Wheels are assembled manually in order to physically check the tension of each individual spoke and achieve an overall homogenous tightening torque, checked spoke by spoke, and to achieve a camber that can guarantee the level of safety and reliability that the ITM brand is famous for.

Please read the instructions provided in this Manual and retain them for future reference.

### BOX

#### Content

- 2 wheels
- 2 quick release levers
- instruction manual
- wheel carrier bag (where foreseen)
- 2 brake pads for carbon wheels

## Assembling the tyres

Check that the diameter and shape of the tyre or tube is compatible with the wheel size. If you have chosen a tube type wheel, wait 24 hours after adhering it the wheel before using it.

**⚠ WARNING!**

Make sure you do not exceed the tyre pressure recommended by the manufacture; excessive pressure could cause lack of grip, whereas low pressure could cause sudden puncturing.

**⚠ WARNING!**

Do your best to avoid situations where the bicycle could endure violent and direct contact with holes and/or uneven roads as this could damage and break the wheel; such damage is not covered by the warranty.

## Quick release levers

The quick release lever has two positions:

- an OPEN position (where the word OPEN is visible)
- a CLOSED position (where the word CLOSE is visible)

**⚠ WARNING!**

Any position other than the CLOSED position could cause serious accidents, causing serious or fatal injuries.

To close the quick release lever correctly, turn the opposite nut until it rests on the fork, and close the lever until you can see the word CLOSE.

If the lever is very easy to close, tighten the opposite nut by at least another ¼ of a turn; on the contrary, if excessive force is needed to close the lever, loosen the nut by 1/8 of a turn each time.

**⚠ WARNING!**

After riding in the rain, or after a period when the bicycle is not used, clean the release pin carefully and grease it where necessary.

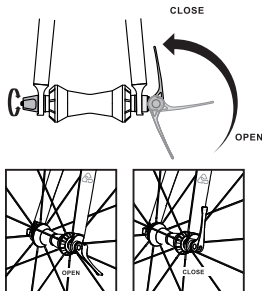

**⚠ WARNING!**

We recommend you position the release levers as seen in the drawing above; this will prevent the remote possibility of them catching on any other objects which would cause them to open unexpectedly.

## Brake system

Check your brake system on a regular basis, there must be no slashes visible on the sheaths and no shredded wires; if this is the case, replace all worn parts immediately. Check that the pads are perfectly aligned with the braking raceway.

**⚠ WARNING!**

If you have purchased our carbon wheels, it is essential you ONLY and EXCLUSIVELY use the pads included in the pack.

The use of other pads could damage the wheel and cause irregular or insufficient braking power.

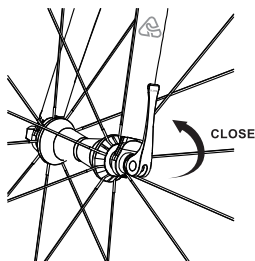

## Periodic maintenance

Check the condition and pressure of your tyres before using your bicycle.

Your wheels should be checked on a regular basis by a specialised mechanic who will lubricate the bearings and check tension and centring values.

Use non-aggressive products, such as neutral detergent and water or specific bicycle cleaning products to clean your wheels; then dry them thoroughly with a soft cloth.

**⚠ WARNING!**

Wheels wear out when used.

Incorrect use of the brake pads can damage the brake raceway.

Check there are no foreign bodies (grit, metal) on the brake pads as this can cause wear and compromise the performance of the wheel.

Use ITM original brake pads only (for carbon wheels)

All modifications will lead to cancellation of all warranty rights.

Check the spoke tension is correct on a regular basis.

The spoke tension should not be excessive.

## Warranty limits

The final decision to repair or substitute the defective items covered by warranty is on discretion of ITM. It is the user's responsibility to check periodically the product to determine whether it is necessary to contact ITM service center.

Claim under this warranty must be made through an authorised ITM dealer. **Together with the warranty card, a proof of purchase is require**

## Not covered by warranty

- Products modified, not correctly used.
- Products not correctly assembled or repaired.
- Products damaged by the use of other materials or assembled by unskilled personnel.
- Products used in competitions, on acrobatic races or during exhibitions.
- Aesthetical finishes.
- Cost of labour for assembling/disassembling.
- Average wear and tear of time.