



LET'S FLY!

Bike Machinery Trading Co.Ltd  
4F-1., No 499, Jhongming S. Rd.,  
West district, Taichung, Taiwan  
itm@biketradng.com.tw

ITM Bike Componets Srl  
Piazza Camozzi, 9  
24064 Grumello del Monte (BG) - Italy  
sales@itm.it

[www.itm.it](http://www.itm.it)

## ITM SEAT-POST USER MANUAL

Thank you for choosing an ITM seat-post, a product that will guarantee performance and safety over time.

Please pay attention to all instructions provided, and follow them carefully

### Assembly instructions

- Check the diameter of the seat-post tube against the diameter of the seat tube on your frame, a difference over 0.15mm could be dangerous.
- Do not apply grease when assembling carbon seat-posts.
- Apply a small amount of grease when assembling aluminium seat posts.

- Follow the instructions relating to the seat-post tightening torque indicated on the part itself.
- An excessive tightening torque can cause serious safety problems.

#### **⚠ WARNING!**

Do not exceed the insertion limit when fitting your frame inside the seat tube. (Fig.1)

Do not overtighten the seat-post screws or the clamp screws.

### Assembling the saddle

#### **⚠ WARNING!**

Attention the drawing of the head is for exemplification purposes only.

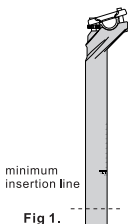

Fig. 1.

### Operations

Remove the screws and grease them.

To assemble the seat correctly, loosen the screws (5), and position the seat fork in the cradle (2).

Position the cover (1) and start to tighten the screws (5) until the seat is parallel to the ground.

If you need increased front or rear inclination, use the wheel (7) to achieve millimetric adjustments.

When the seat is positioned as desired, tighten the screws (5) to 8-10Nm.

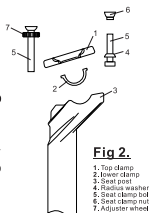

Fig. 2.

1. Top clamp
2. lower clamp
3. Seat post
4. Radius washer
5. Seat clamp bolt
6. Seat clamp nut
7. Adjuster wheel

For other heads that require other structure types, follow the assembly instructions provided above; if in doubt or if the drawings are different, please contact the ITM Technical Advice service.

Our seat-posts are produced with heads which rails in carbon or with rounded shapes made from a variety of different materials.

The standard closing range of the rail is set at a diameter of 8mm.

#### **⚠ WARNING!**

Incorrect tightening can cause undesired movement of the seat and consequential physical injuries.

### Periodic maintenance

- Check the seat-post regularly, if you notice any signs of damage, replace the damaged parts immediately.
- Check the correct tightening torque regularly.
- Replace all screws every two years.

### Warranty limits

The final decision to repair or substitute the defective items covered by warranty is on discretion of ITM. It is the user's responsibility to check periodically the product to determine whether it is necessary to contact ITM service center.

### Not covered by warranty

- Products modified, not correctly used.
- Products not correctly assembled or repaired.
- Products damaged by the use of other materials or assembled by unskilled personnel.
- Products used in competitions, on acrobatic races or during exhibitions.
- Aesthetical finishes.
- Cost of labour for assembling/disassembling.
- Average wear and tear of time.